

*TO AVOID FAILURE, PLEASE ASSEMBLE ALL THE PARTS COMPLETELY BEFORE USING.
 * UNTUK MENGEKALAKAN KESILAPAN, SILA PASANGKAN SEMUA BAHAGIAN KIPAS SEBELUM MENGGUNA.

PART IDENTIFICATION / PENGENALAN BAHAGIAN KIPAS

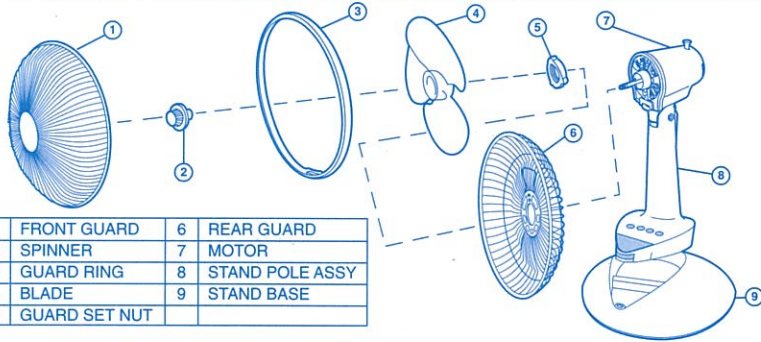

1	FRONT GUARD	6	REAR GUARD
2	SPINNER	7	MOTOR
3	GUARD RING	8	STAND POLE ASSY
4	BLADE	9	STAND BASE
5	GUARD SET NUT		

ASSEMBLY METHOD / CARA-CARA PEMASANGAN

1. Remove all the parts from the carton box.
1. Keluarkan semua barang dari dalam kotak.

2. • Remove the P.V.C tube.
• Remove the guard set nut by turning anti-clockwise.
2. • Keluarkan tiub P.V.C.
• Keluarkan "guard set nut" dengan cara pusing ke arah lawan jam.

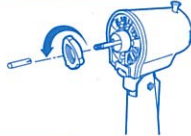

1. Match stand pole assembly to stand base.
1. Padankan "stand pole assembly" ke "stand base".
2. Fix the stand pole assembly according to the arrow direction until a click sound is heard.
2. Pasangkan "stand pole assembly" mengikut arah anak panah sehingga kedengaran bunyi "klik".

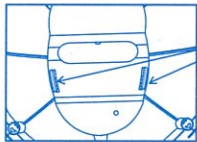

3. Make sure both of Stand Pole Nail to be fix inside the stand base hole firmly.
3. Pastikan kedua-dua Stand Pole Rib masuk ke dalam lubang stand base dengan sempurna.

View from bottom of stand base
 Pandangan dari bawah stand base



4. Fix the rear guard into the motor guide (A).
4. Pasangkan "rear guard" mengikut tanda panduan (A).
5. Fasten the rear guard tightly by turning the guard set nut clockwise.
5. Pasang "rear guard" dengan mengetatkan "guard set nut" mengikut arah jam.

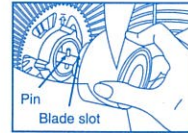

6. Insert the blade to the shaft and ensure the pin must enter the blade slot.
6. Masukkan "blade" pada "shaft" dan pastikan pin memasuki lurah "blade".



7. Tighten the blade using the spinner. Turn anti-clockwise.
7. Ketatkan "blade" dengan menggunakan "spinner". Pusingkan mengikut arah lawan jam sehingga ketat.

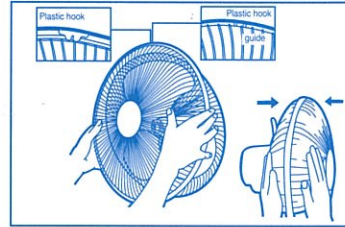

8. • Fix the front guard with the logo in the upright position.
• Fix the plastic hook onto the rear guard as shown.
8. • Pasangkan "front guard" dan tentukan logo dalam kedudukan yang betul.
• Pasangkan "plastic hook" ke arah "rear guard" seperti di gambarajah.

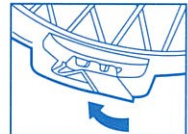

9. Press on the clip.
9. Tekan klip.

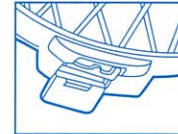

- ✗ Securely snap together the front and rear guards by pressing on the clip. Otherwise the front guard may fall off.
✗ Sila pastikan "front guard" dan "rear guard" terlekat dengan menekan klip pengunci. Jika tidak "front guard" akan jatuh.

TO DISMANTLED BASE AND POLE / CARA MEMBUKA BASE DAN POLE

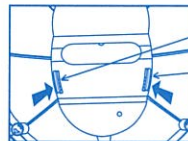

First Stand Pole Nail
 Stand Pole Rib Pertama
 Second Stand Pole Nail
 Stand Pole Rib Kedua

- * Push the First Stand Pole Nail and followed by the Second Stand Pole Nail.
* Tekan Stand Pole Rib Pertama dan diikuti dengan Stand Pole Rib Kedua.



- * Hold the Stand Pole and pull the base towards opposite direction.
* Pegang Stand Pole dan tarik stand base ke arah bertentangan.

SPECIFICATION / SPESIFIKASI

MODEL	VOLTAGE(V~) VOLTAN	FREQ.(Hz) FREKUENSI	POWER(W) KUASA	SPEED/KELAJUAN (RPM)			AIR VELO. m/min	AIR DEL. m ² /min
				1	2	3		
KB304	240	50	39	875 ~	1053 ~	1123 ~	214	43
				1074	1287	1373		
KB404	240	50	55	774 ~	949 ~	1103 ~	228	63
				946	1159	1349		

Specification are subject to change without notice with the development of technology.
 Spesifikasi adalah tertakluk pada pertukaran tanpa notis selaras dengan perkembangan teknologi.